

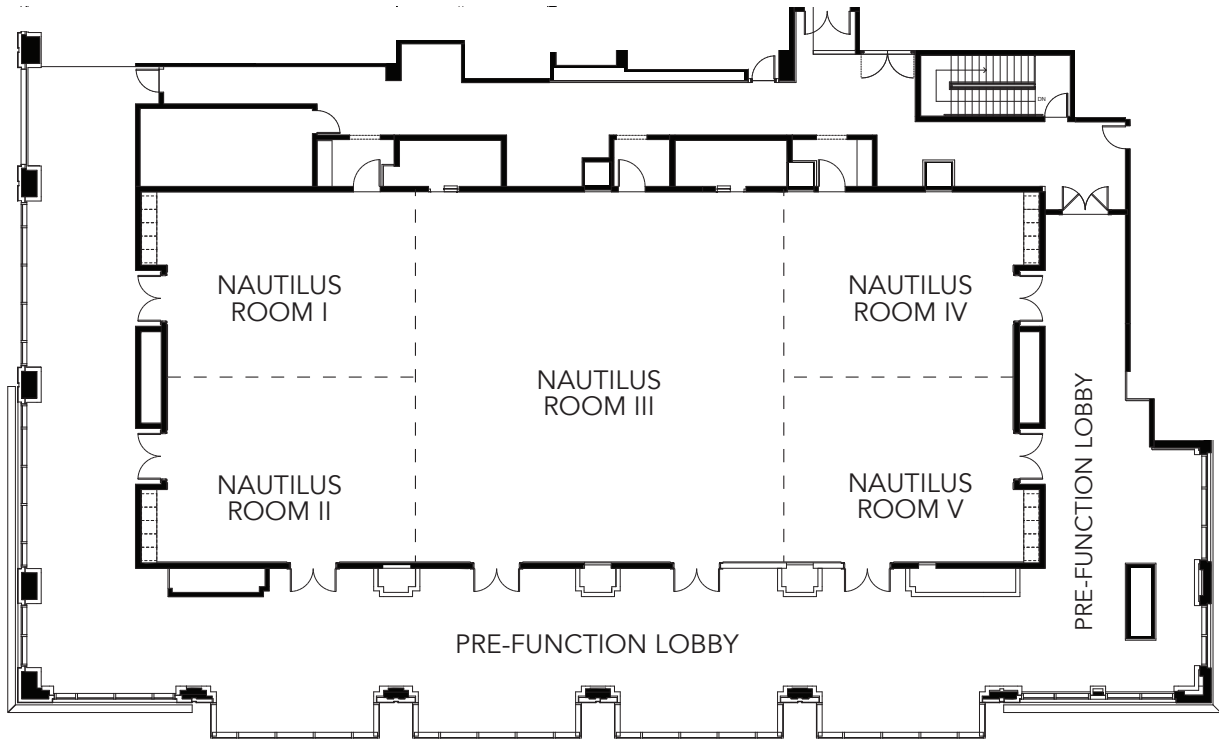

DAYTONA GRANDE

OCEANFRONT RESORT



Nautilus Ballroom Conference Specs & Capacities

FUNCTION ROOM	FT ²	DIMENSIONS	CEILING	CLASSROOM	THEATER	CONF	U-SHAPE	BANQUET	RECEPTION	H-SQUARE	BOOTHS	TT EXHIBIT
Nautilus Ballroom	5,346	116' x 50'	14'	273	400	68	76	280	535	88	36	48
Nautilus Room I	870	24'16" x 36'	14'	42	72	30	28	60	87	32	6	-
Nautilus Room II	864	24' x 36'	14'	42	72	30	28	60	87	32	6	-
Nautilus Room I & II	1,734	48'16" x 36'	14'	84	150	36	40	120	185	54	12	-
Nautilus Room III	1,830	48'16" x 38'	14'	105	150	36	46	120	183	62	12	-
Nautilus Room I, II & III	3,564	48'16" x 74'	14'	147	240	48	70	240	356	84	24	-
Nautilus Room IV	894	24'16" x 37"	14'	42	84	30	28	60	89	32	6	-
Nautilus Room V	888	24' x 37'	14'	42	84	30	28	60	89	32	6	-
Nautilus Room III, IV & V	3,612	48'16" x 74'	14'	147	260	48	70	240	361	84	24	-
Nautilus Room IV & V	1,782	48'16" x 37'	14'	84	150	36	40	120	178	54	12	-
Nautilus Pre-Function Entrance	908	75' x 12'	-	-	-	-	-	-	90	-	-	-
Nautilus Pre-Function Lobby	1,527	130' x 12'	-	-	-	-	-	-	150	-	-	15
Nautilus Pre-Function N-Side	517	49 x 10'5"	-	-	-	-	-	-	50	-	-	-