



DAYTONA GRANDE

OCEANFRONT RESORT

▲ ATLANTIC OCEAN

▲ ATLANTIC OCEAN

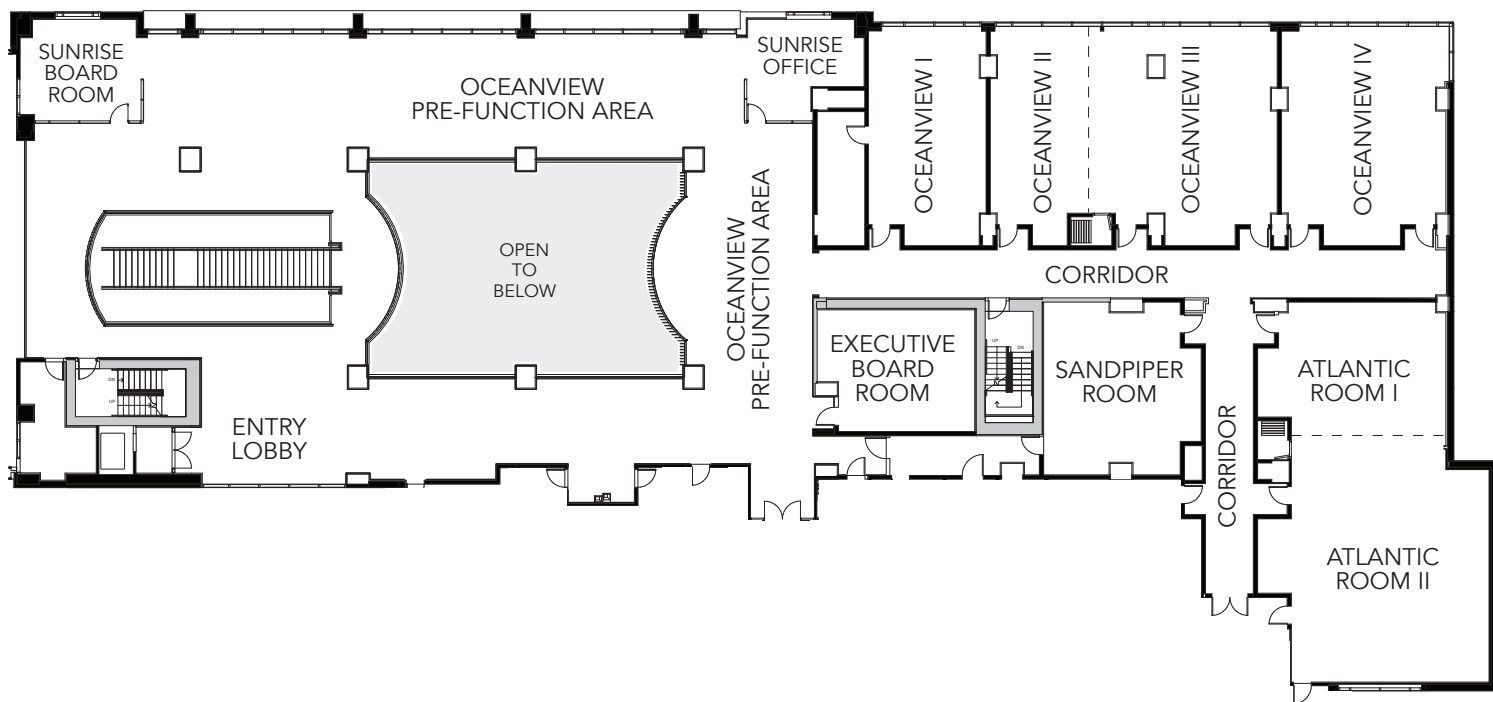

Mezzanine Level Conference Specs & Capacities

FUNCTION ROOM	FT ²	DIMENSIONS	CEILING	CLASSROOM	THEATER	CONFERENCE	U-SHAPE	BANQUET	RECEPTION	H-SQUARE
OceanView Pre-Function	1,620	18' x 90'	10'	–	–	–	–	135	162	–
OceanView Room I	640	32' x 20'	10'	30	40	30	21	30	64	24
OceanView Room II	468	18' x 26'	10'	30	40	30	21	30	47	24
OceanView Rooms II&III	1,196	46' x 26'	10'	60	95	34	35	70	120	40
OceanView Room III	728	28' x 26'	10'	42	54	22	23	40	73	28
OceanView Room IV	837	31' x 27'	10'	39	72	22	23	40	84	28
Atlantic Ballroom	1,960	56' x 26'	10'	84	128	36	36	120	145	42
Atlantic Room I	700	28'5" x 24'	10'	33	48	16	20	40	68	26
Atlantic Room II	1,260	35' x 36'	10'	48	80	24	32	80	77	40
Executive Board Room	402	21'75" x 18'5"	10'	–	–	10	–	–	–	–
Sandpiper Boardroom	575	23' x 25'	10'	21	45	16	20	30	66	26
Sunrise Office	275	8' x 11'	10'	–	–	–	–	–	–	–
Sunrise Boardroom	275	8' x 11'	10'	–	–	8	–	–	–	–