

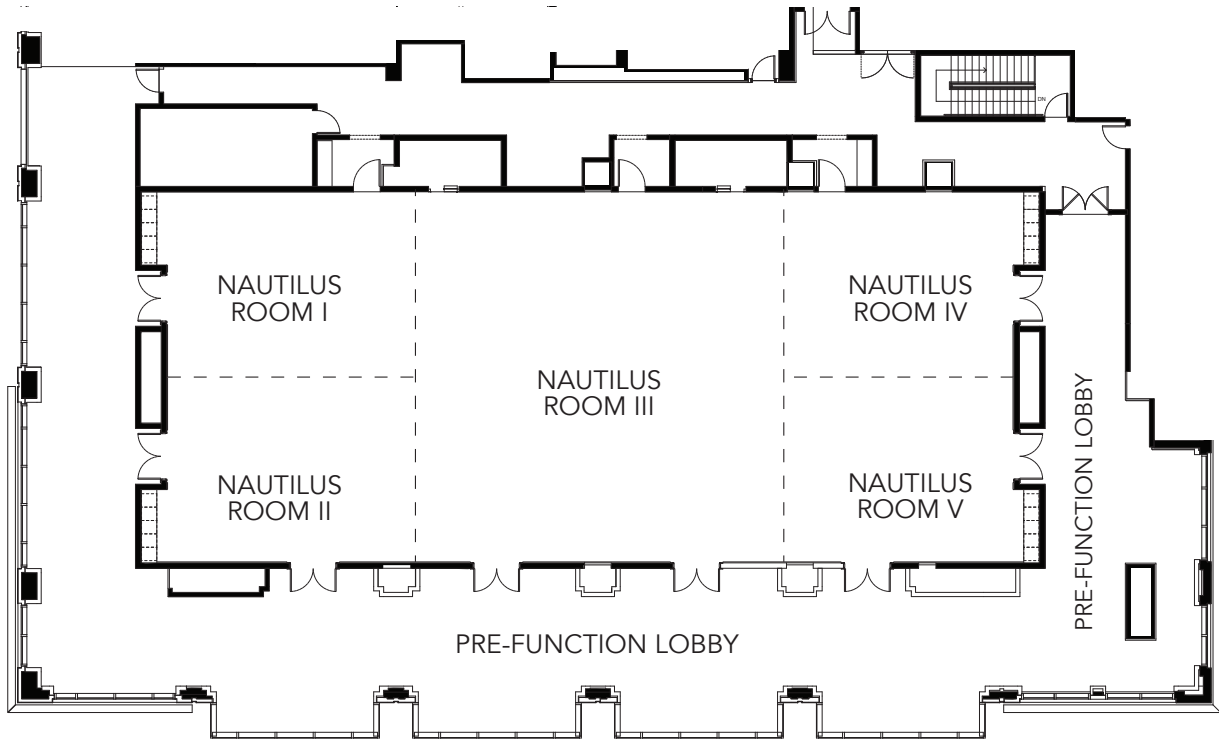

# DAYTONA GRANDE

OCEANFRONT RESORT



## Nautilus Ballroom Conference Specs & Capacities

FUNCTION ROOM	FT <sup>2</sup>	DIMENSIONS	CEILING	CLASSROOM	THEATER	CONF	U-SHAPE	BANQUET	RECEPTION	H-SQUARE	BOOTHS	TT EXHIBIT
Nautilus Ballroom	5,346	116' x 50'	14'	223	593	128	153	445	535	130	36	48
Nautilus Room I	870	24'16" x 36'	14'	36	97	21	25	72	87	21	6	-
Nautilus Room II	864	24' x 36'	14'	36	97	21	25	72	87	21	6	-
Nautilus Room I & II	1,734	48'16" x 36'	14'	72	192	42	50	144	185	42	12	-
Nautilus Room III	1,830	48'16" x 38'	14'	76	203	44	52	152	183	44	12	-
Nautilus Room I, II & III	3,564	48'16" x 74'	14'	148	396	86	102	297	356	86	24	-
Nautilus Room IV	894	24'16" x 37"	14'	37	99	21	26	74	89	21	6	-
Nautilus Room V	888	24' x 37'	14'	37	99	21	26	74	89	21	6	-
Nautilus Room III, IV & V	3,612	48'16" x 74'	14'	150	401	87	103	301	361	87	24	-
Nautilus Room IV & V	1,782	48'16" x 37'	14'	74	198	43	51	148	178	43	12	-
Nautilus Pre-Function Entrance	908	75' x 12'	-	-	-	-	-	-	90	-	-	-
Nautilus Pre-Function Lobby	1,527	130' x 12'	-	-	-	-	-	-	150	-	-	15
Nautilus Pre-Function N-Side	517	49 x 10'5"	-	-	-	-	-	-	50	-	-	-