



# DAYTONA GRANDE

OCEANFRONT RESORT

▲ ATLANTIC OCEAN

▲ ATLANTIC OCEAN

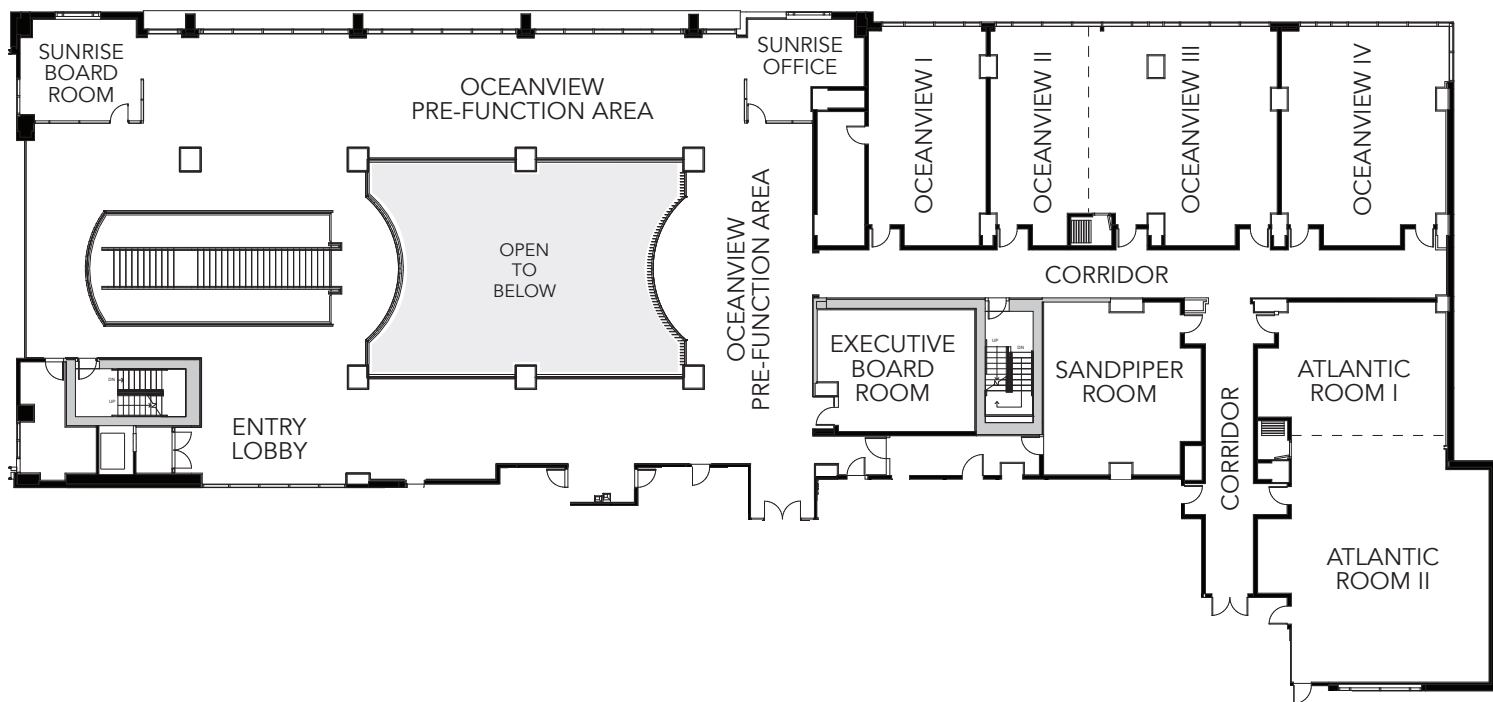

## Mezzanine Level Conference Specs & Capacities

FUNCTION ROOM	FT <sup>2</sup>	DIMENSIONS	CEILING	CLASSROOM	THEATER	CONFERENCE	U-SHAPE	BANQUET	RECEPTION	H-SQUARE
OceanView Pre-Function	1,620	18' x 90'	10'	–	–	–	–	135	162	–
OceanView Room I	640	32' x 20'	10'	27	71	15	18	53	64	15
OceanView Room II	468	18' x 26'	10'	19	52	11	13	39	47	11
OceanView Rooms II&III	1,196	46' x 26'	10'	50	133	29	34	100	120	29
OceanView Room III	728	28' x 26'	10'	30	81	17	21	61	73	17
OceanView Room IV	837	31' x 27'	10'	35	93	20	24	70	84	20
Atlantic Ballroom	1,960	56' x 26'	10'	60	161	35	41	163	145	35
Atlantic Room I	700	28'5" x 24'	10'	28	76	16	20	57	68	16
Atlantic Room II	1,260	35' x 36'	10'	32	85	18	22	64	77	18
Executive Board Room	402	21'75" x 18'5"	10'	17	45	10	11	33	40	10
Sandpiper Boardroom	575	23' x 25'	10'	28	74	16	19	55	66	16
Sunrise Office	275	8' x 11'	10'	–	–	–	–	–	–	–
Sunrise Boardroom	275	8' x 11'	10'	–	–	8	–	–	–	–