



# DAYTONA GRANDE

OCEANFRONT RESORT

▲ ATLANTIC OCEAN

▲ ATLANTIC OCEAN

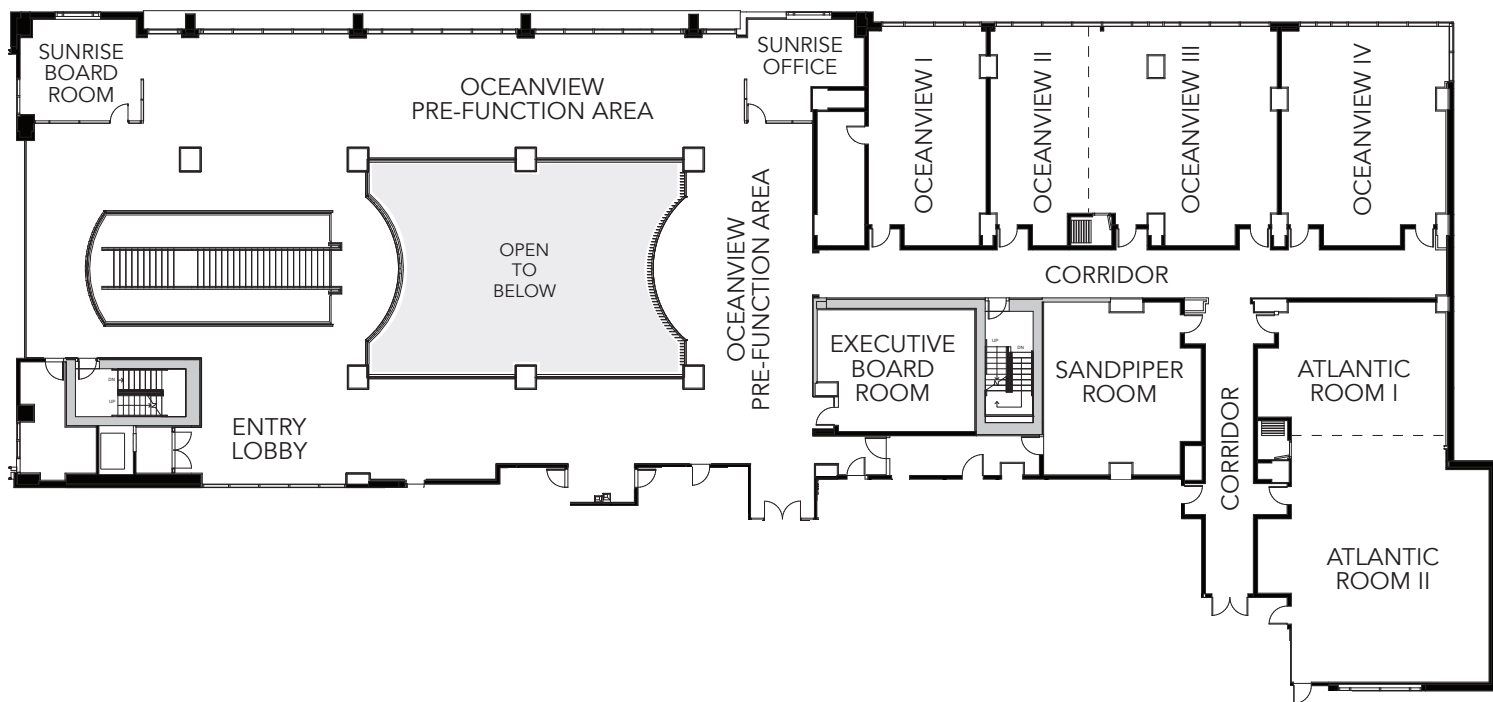

## Mezzanine Level Conference Specs & Capacities

FUNCTION ROOM	FT <sup>2</sup>	DIMENSIONS	CEILING	CLASSROOM	THEATER	CONFERENCE	U-SHAPE	BANQUET	RECEPTION	H-SQUARE	BOOTHS
OceanView Pre-Function	1,000	101' x 20'	10'	-	-	-	-	-	100	-	6
OceanView Room I	660	20' x 33'	10'	27	73	16	19	55	66	16	4
OceanView Room II	636	19' x 33'5"	10'	26	71	15	18	53	64	15	4
OceanView Rooms II&III	1,608	48' x 33'5"	10'	67	178	39	46	134	161	39	10
OceanView Room III	972	29' x 33'5"	10'	40	108	23	28	81	97	23	6
OceanView Room IV	908	27'5" x 33'	10'	38	101	22	26	76	91	22	6
Atlantic Ballroom	1,450	56' x 26'	10'	60	161	35	41	121	145	35	9
Atlantic Room I	684	28'5" x 24'	10'	28	76	16	20	57	68	16	4
Atlantic Room II	850	32' x 36'	10'	32	85	18	22	64	77	18	5
Executive Board Room	402	21'75" x 18'5"	10'	17	45	10	11	33	40	10	-
Sandpiper Boardroom	663	26'5" x 25'	10'	28	74	16	19	55	66	16	-
Sunrise Office	275	8' x 11'	10'	-	-	-	-	-	-	-	-
Sunrise Boardroom	275	8' x 11'	10'	-	-	8	-	-	-	-	-