

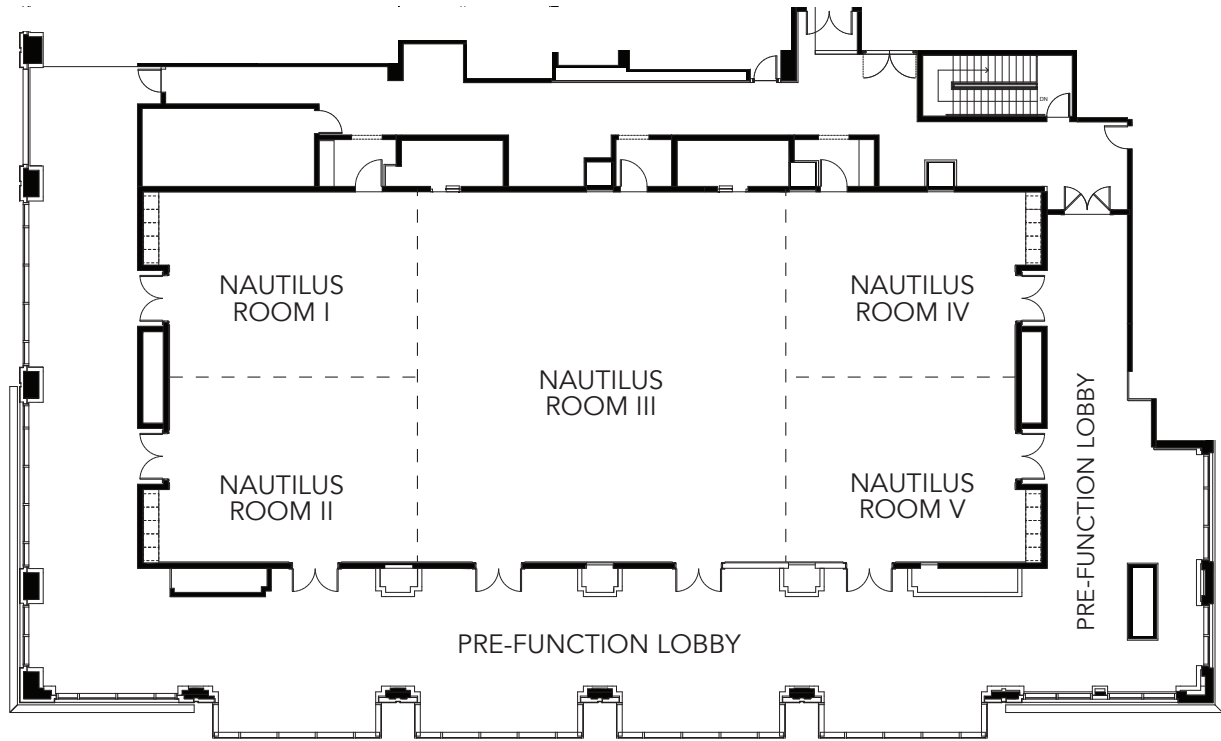

# DAYTONA GRANDE

OCEANFRONT RESORT



## Nautilus Ballroom Conference Specs & Capacities

FUNCTION ROOM	FT <sup>2</sup>	DIMENSIONS	CEILING	CLASSROOM	THEATER	CONFERENCE	U-SHAPE	BANQUET	RECEPTION	H-SQUARE	BOOTHS
Nautilus Ballroom	5,800	116' x 50'	17'	235	600	140	150	475	550	139	36
Nautilus Room I	950	38' x 25'	17'	40	100	23	27	80	100	23	-
Nautilus Room II	950	38' x 25'	17'	40	100	23	27	80	100	23	-
Nautilus Room I & II	1,900	38' x 50'	17'	75	200	45	44	144	190	45	12
Nautilus Room III	1,950	39' x 50'	17'	80	200	47	50	160	200	47	12
Nautilus Room IV	975	39' x 25'	17'	40	100	23	26	80	100	23	6
Nautilus Room V	975	39' x 25'	17'	40	100	23	26	80	100	23	6
Nautilus Room IV & V	1,950	38' x 50'	17'	80	200	47	50	160	200	47	12