

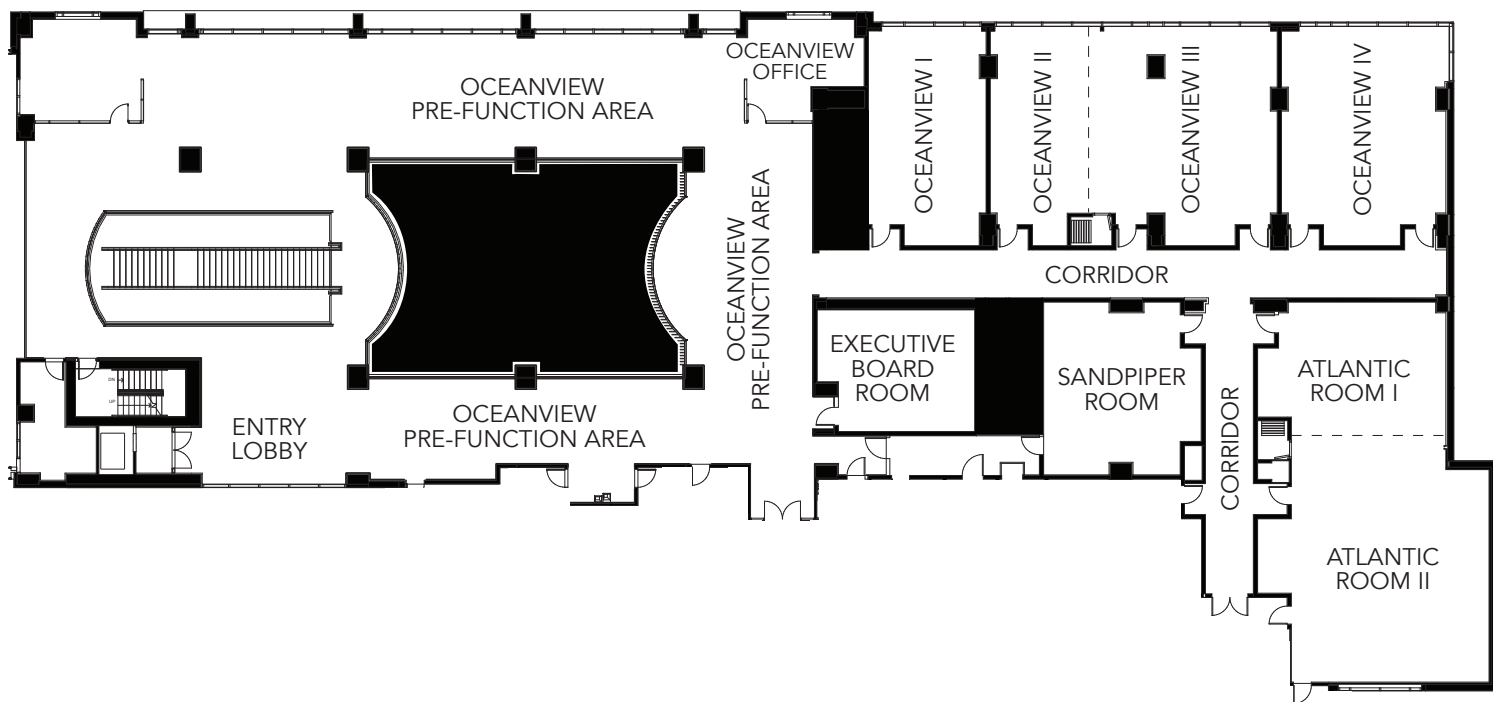

DAYTONA GRANDE

OCEANFRONT RESORT

▲
ATLANTIC OCEAN



Mezzanine Level Conference Specs & Capacities

FUNCTION ROOM	FT ²	DIMENSIONS	CEILING	CLASSROOM	THEATER	CONFERENCE	U-SHAPE	BANQUET	RECEPTION	H-SQUARE	BOOTHS
OceanView Pre-Function	1,000	115' x 50'	10'	-	-	-	-	-	100	-	6
OceanView Room I	650	32' x 19'	10'	25	65	16	19	54	65	16	4
OceanView Room II	575	32' x 19'	10'	24	60	14	16	48	60	14	4
OceanView Rooms II&III	1,525	32' x 47'	10'	64	165	37	42	125	150	37	10
OceanView Room III	950	32' x 28'	10'	40	100	23	27	80	90	23	6
OceanView Room IV	950	32' x 27'	10'	40	100	23	27	80	90	23	6
OceanView Office	275	8' x 11'	10'	-	-	-	-	-	-	-	-
Atlantic Ballroom	1,450	56' x 26'	10'	60	150	35	40	120	150	35	9
Atlantic Room I	650	27' x 23'	10'	25	60	15	18	50	65	15	4
Atlantic Room II	850	32' x 36'	10'	35	90	20	22	70	85	20	5
Sandpiper Room	650	23' x 28'	10'	25	65	16	19	54	65	16	4
Executive Board Room	505	20' x 25'	10'	-	-	12	-	-	-	-	-